

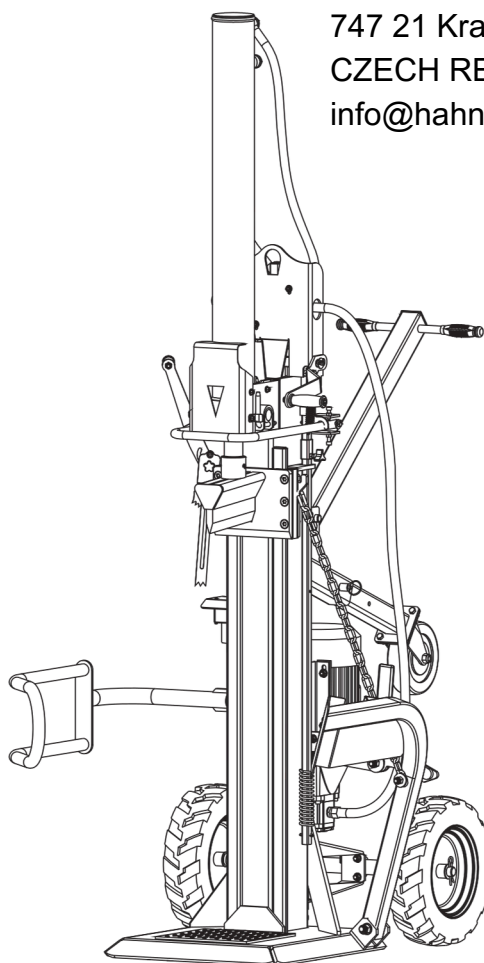

HAHN A SYN s.r.o.
Lelkova 186/4
747 21 Kravaře
CZECH REPUBLIC
info@hahn-profi.cz

Hahn & Sohn GmbH
Janahof 53
93413 Cham
Deutschland
hahn@hahn-sohn.de



Hydraulic Log Splitters

Operator's Manual

MODEL NUMBER: ☐ **CEDLS10V**

SERIAL NUMBER: _____

Both model number and serial number may be found on the main label.
You should record both of them in a safe place for future use.

FOR YOUR SAFETY

READ AND UNDERSTAND THE ENTIRE MANUAL BEFORE OPERATING
MACHINE



TABLE OF CONTENTS

Introduction

Symbols

Safety

Safety Warnings &

Instructions Specifications

Contents Supplied Assembly Transport

Delivering Log Splitter To Work Site

Splitter Operation Free a Jammed Log

Replacing Oil Sharpening Wedge

Trouble Shooting Wiring Diagram

Hydraulic System Diagram Parts

Schematic

Copyright © 2014 by Husqvarna

ENVIRONMENTAL



Recycle unwanted materials instead of disposing of them as waste. All tools, hoses and packaging should be resorted, taken to the local recycling center and disposed of in an environmentally safe way.

SYMBOLS

The rating plate on your machine may show symbols. These represent important information about the product or instructions on its use.



Read these instructions in full before using the machine.



Wear safety footwear!



Wear protective gloves!



Wear eye protection! Wear hearing protection!



Keep your work space tidy! Untidiness may result in accidents.



Do not remove or tamper with any protection or safety devices.



Do not smoke or have open flames.



Dispose of the used oil in an environment-friendly way.



Do not use in the rain.

INTRODUCTION

Your new log splitter will more than satisfy your expectations. It has been manufactured under stringent quality standards to meet superior performance criteria. You will find your new unit easy and safe to operate, and with proper care, it will give you many years of dependable service.



Carefully read through this entire operator's manual before using your new log splitter. Take special care to heed the cautions and warnings.



Danger! Keep clear of moving parts!



Do not remove jammed logs with your hands.



Caution! Thrown objects.



Before starting any repair maintenance or cleaning, always disconnect the power.



Avoid injury from the movement of the splitting blade.



Keep bystanders away from the working area.

around the work area. Do not use the log splitter in wet or damp areas or expose it to rain. Do not use it in areas where fumes from paint, solvents or flammable liquids pose a potential hazard.

•INSPECT YOUR LOG SPLITTER

Check your log splitter before turning it on. Keep guards in place and in working order. Form a habit of checking to see that keys and adjusting wrenches are removed from tool area before turning it on. Replace damaged, missing or failed parts before using it. Make sure all nuts, bolts, screws, hydraulic fittings, hose clamps, etc. are securely tightened. Always check the oil level in the hydraulic oil tank. Never operate your log splitter when it is in need of repair or is in poor mechanical condition. Before starting work, test the stopping devices to keep them in safe working condition.

SAFETY

Safety Warnings&Instructions

•UNDERSTAND YOUR LOG SPLITTER

Read and understand the owner's manual and labels affixed to the log splitter. Learn its application and limitations as well as the specific potential hazards peculiar to it. Be thoroughly familiar with the controls and their proper operation.

• DRUGS, ALCOHOL AND MEDICATION

Do not operate the log splitter while under the influence of drugs, alcohol, or any medication that could affect your ability to use it properly.

•AVOID DANGEROUS CONDITIONS

Always operate your log splitter on dry, solid, level ground. Never operate your log splitter on slippery, wet, muddy, or icy surfaces. The location you choose should be free from any tall grass, brush, or other interferences. There should be plenty of room for handling, and help the operator stay alert. Keep your work area clean and well lighted. Cluttered areas invites injuries. To avoid tripping, do not leave tools, logs, or other components laying

•DRESS PROPERLY

Do not wear loose clothing, gloves, neckties or jewelry (rings, wrist watches). They can be caught in moving parts. Protective electrically non-conductive gloves, non-skid footwear and hearing protection are recommended when working. Wear protective hair covering to contain long hair, preventing it from get caught in machinery.

•PROTECT YOUR EYES AND FACE

Any log splitter may throw foreign objects into the eyes. This can cause permanent eye damage. Always wear safety goggles. Everyday eyeglasses have only impact resistant lenses. They are not safety glasses.

EXTENSION CORDS

•

Improper use of extension cords may cause inefficient operation of the log splitter which can result in overheating. Be sure the extension cord is no longer than 10m and its section is no less than 2.5mm² to allow sufficient current flow to the motor. Avoid use of free and inadequately insulated connections. Connections must be made with protected material suitable for outdoor use.



•AVOID ELECTRICAL SHOCK

Check that the electric circuit is adequately protected and that it corresponds with the power, voltage and frequency of the motor. Check that there is a ground connection. Ground the log splitter. Prevent body contact with grounded surfaces: pipes, radiators, ranges, and refrigerator enclosures. Never open the switch / plug box. Should this be necessary, contact a qualified electrician. Make sure your fingers do not touch the plug's metal prongs when plugging or unplugging the log splitter.

•PREVENT FIRES

Do not smoke or have open flames when operating or refilling the log splitter. Never operate the log splitter near a flame or spark. Oil is flammable and can be exploded.

•KEEP BYSTANDERS AWAY

Allow only one person to load and operate the log splitter. Always keep bystanders, including visitors, children and pets away from the work area, especially when the log splitter is under operations. Only the operator should stand near the machine and only within the safe operating area prescribed in this manual. Never use another people to help you with freeing jammed log. No one under the age of 16 should be allowed to operate the log splitter. Any individual under the age of 18 should has the necessary training, skills to perform the functions properly and safely and should always be under the supervision of adult.

•INSPECT YOUR LOG

Never attempt to split logs containing nails, wire or debris. Always make sure that both ends of the log you are splitting are cut as square as possible. This will prevent the log from sliding out of position while under pressure. Branches must be cut of flush with the trunk.

•DON'T OVERREACH

Keep proper footing and balance at all times. Never stand on log splitter. Serious injury could occur if the tool is tipped or if the cutting tools is unintentionally contacted. Do not store anything above or near the log splitter where anyone might stand on the tool to reach them.

AVOID INJURY FROM UNEXPECTED ACCIDENT

Do not straddle or reach across the splitting area when operating the log splitter. Never pile logs to be split in a manner that will cause you to reach across the log splitter. Only use your hands to operate the control levers. Never use your foot, knee, a rope, or any other extension device. Always pay full attention to the movement of the wedge ram. Never attempt to load your log splitter while the ram is in motion. Keep hands out of the way of all moving parts. Never try to split two logs on top of each other. One of them may fly up and hit you.

•PROTECT YOUR HANDS

Keep your hands away from splits and cracks which open in the log. They may close suddenly and crush or amputate your hands. Do not remove jammed logs with your hands.

•DON'T FORCE TOOL

It will do a better and safer job at its design rate. Don't use log splitter for a purpose for which it was not intended. Do not alter the equipment, or use the equipment in such a way as to circumvent its design capabilities and capacities. Never try to split logs larger than those indicated in the specifications table.

•DISCONNECT POWER

Unplug when not in use, before making adjustments, changing parts, cleaning, or working on the log splitter. Consult technical manual before servicing.



* S6 40%, continuous operation periodic duty: time of one load cycle is 10 minutes, operation time at constant load is 4 minutes, operation time at no-load is 6 minutes.

APPLICATION CONDITIONS

This log splitter is designed for operating under ambient temperatures between +5°C and 40°C and for installation at altitudes no more than 1000m above M.S.L. The surrounding humidity should be less than 50% at 40°C. It can be stored or transported under ambient temperatures between -25°C and 55°C.

ELECTRICAL REQUIREMENTS

With 3 phase 400 Volt / 50Hz motor, the log splitter should be connected to standard 400V±10% / 50Hz±1%Hz.

Electrical supply which has protection devices of under-voltage, over-voltage, over-current as well as a residual current device (RCD) which maximum residual current rated at 0.03A.

The mains connection and extension cable must have 5 wires = 3P + N + PE (3/N/PE). The mains connection must have maximum 16 A fuse. Electrical connection rubber cables must comply with EN60245 which are always marked with symbol H 07 RN. Cables should be identified, as it is a legal requirement.

CONTENTS SUPPLIED

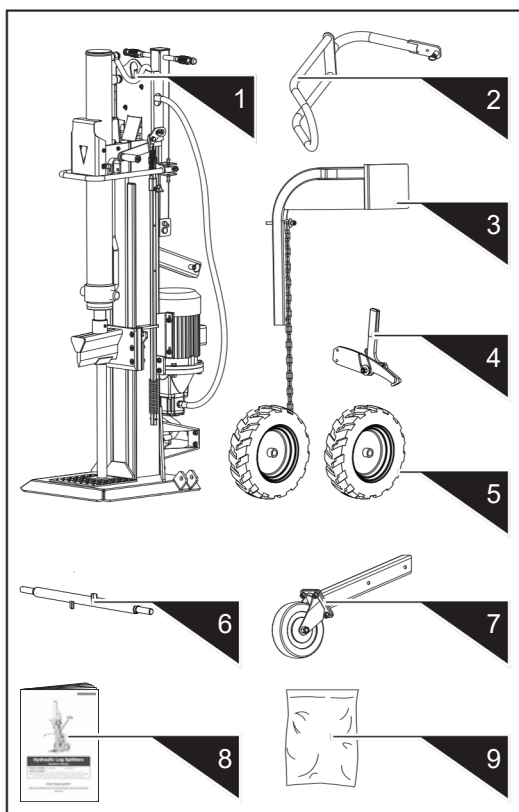

1.Log Splitter Frame & Power Station

2.Guard Arm 3.Log Lift
4.Retaining Hook 5. Wheel
6.Wheel Shaft 7.Support
Wheel 8.Operator's Manual
9.Hardware Bag, including

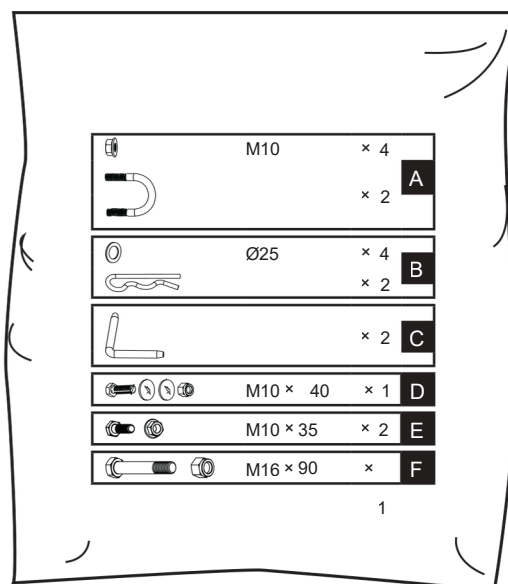



ASSEMBLY

1. Attach the wheel shaft to the splitter with U-bolts and lock nuts.

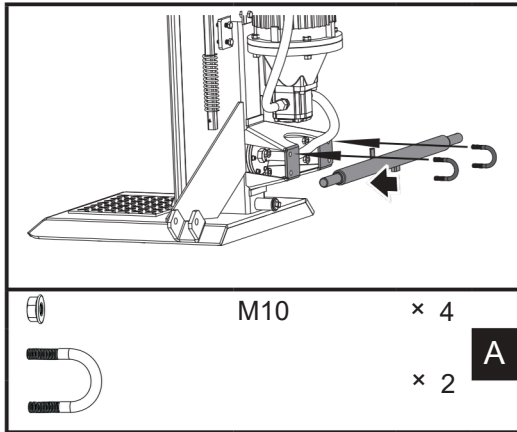

2. Place a washer onto the axle, then a wheel followed by another washer, and secure with a hairpin retainer. Repeat above procedure for the other side.

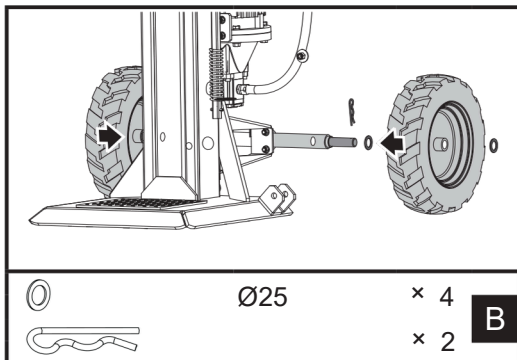

3. Keeping the support stand against the wedge, lower both control handles to expand wedge ram. Insert the L pins to secure the cylinder to the splitter. Lock the L pins into the spring tabs.

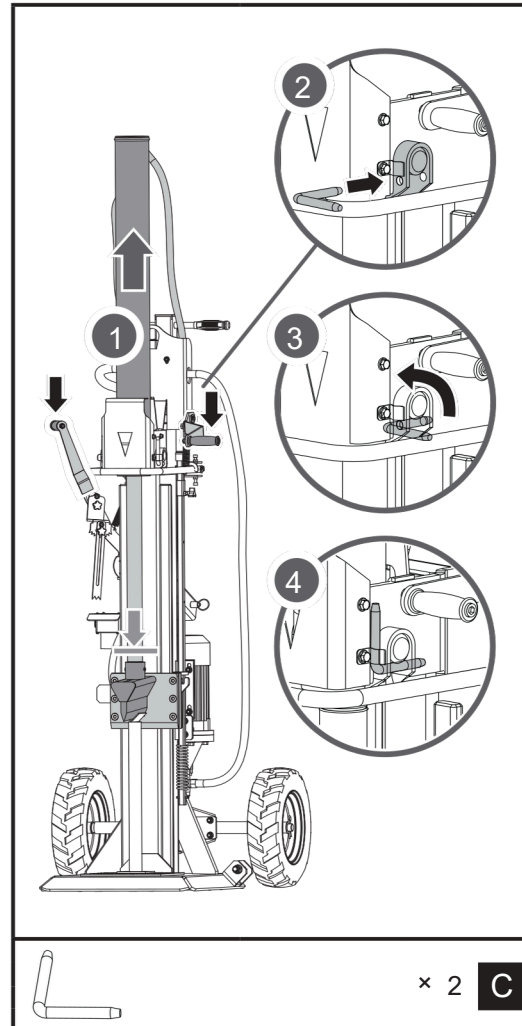



4. Release both control handles to retract the wedge ram. Remove the support stand.

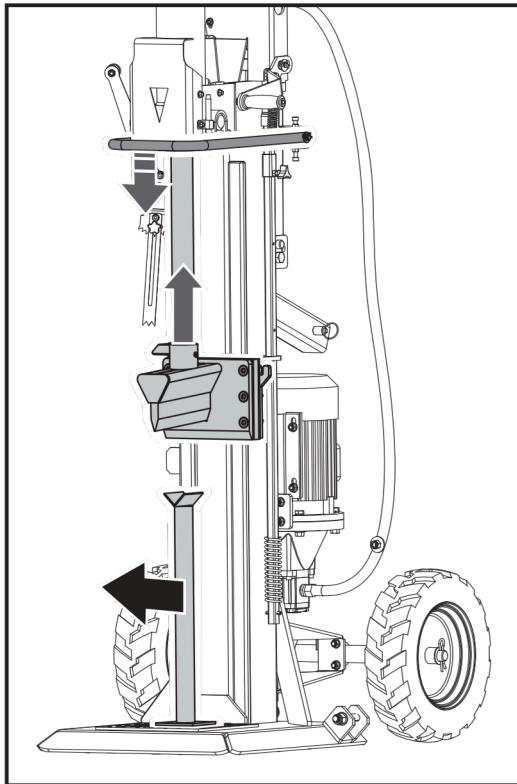

6. Position the retaining hook onto the frame and secure with two M10×35 hex bolts and nuts.

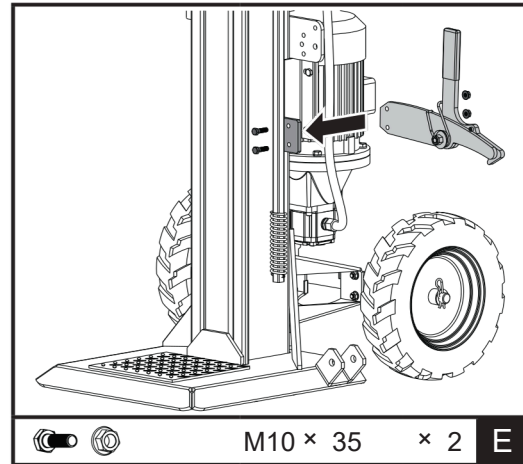

5. Align the hole and locking pin of the guard arm with the mount bracket. Secure the guard arm with a M10 × 40 hex bolts, two washers and a nut from the hardware bag.

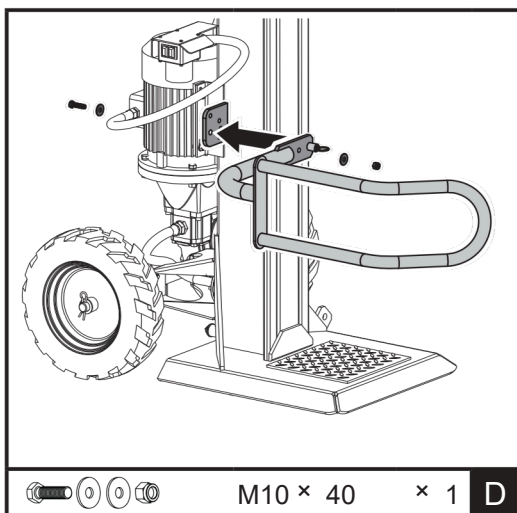

7. Position the bag lift and align with mounting bracket holes. Secure with a M16×90 hex bolt and nut. Hook the lift chain to wedge slide guide.

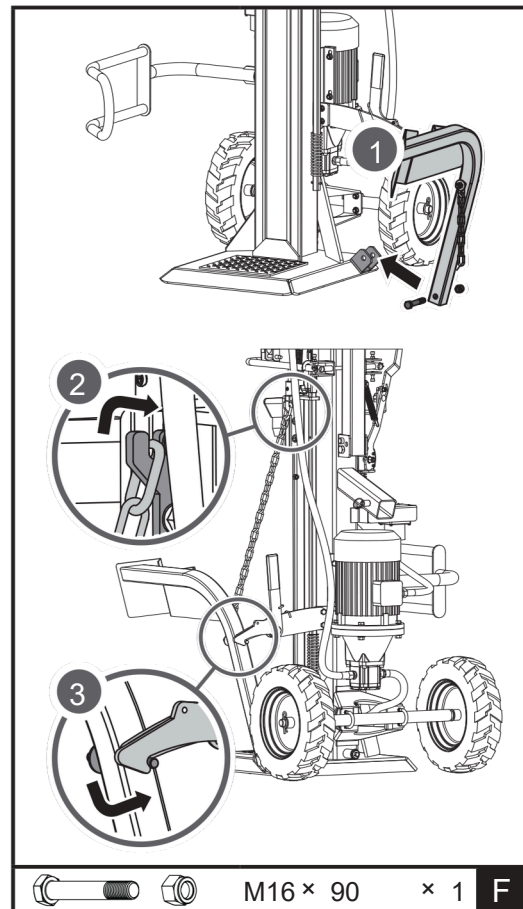



TRANSPORT

Pull the spring pin and slide the square tube of the support wheel into the holder. Loosen the spring pin to fix it after selecting the appropriate hole.

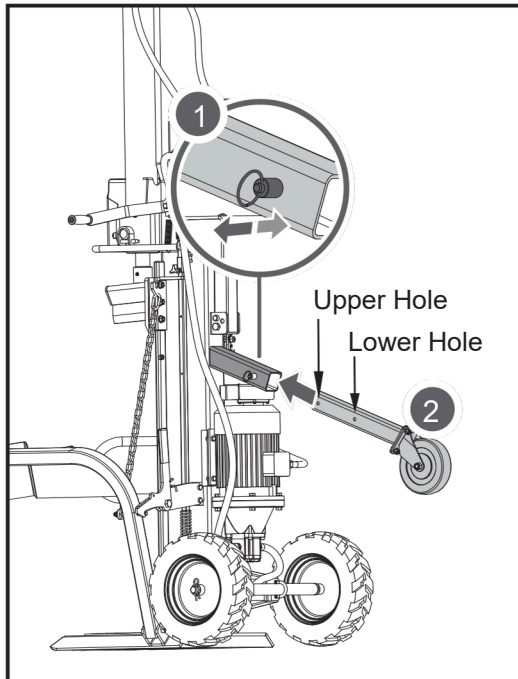

The transporting handle is fixed upright by the pin with clip for easier delivery.

Remove the clip and pin. lower the handle in the direction of the arrow as shown and secure it by fixing the pin with clip to the outer hole.

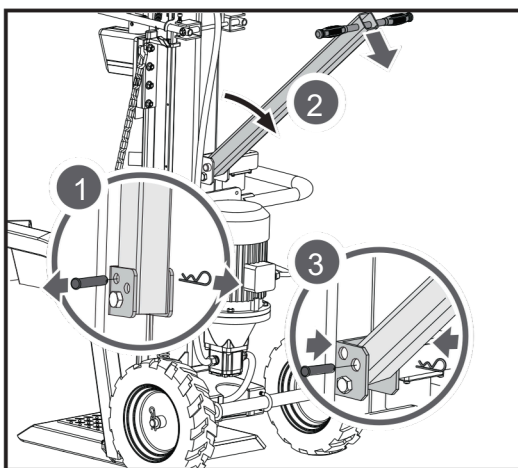

DELIVERING LOG SPLITTER TO WORK SITE

The log splitter is equipped with 2 wheels for minor moving. To move the log splitter to the work site. Grip the handle (b) to tilt the log splitter slightly after making sure the oil tank cover is tightened.

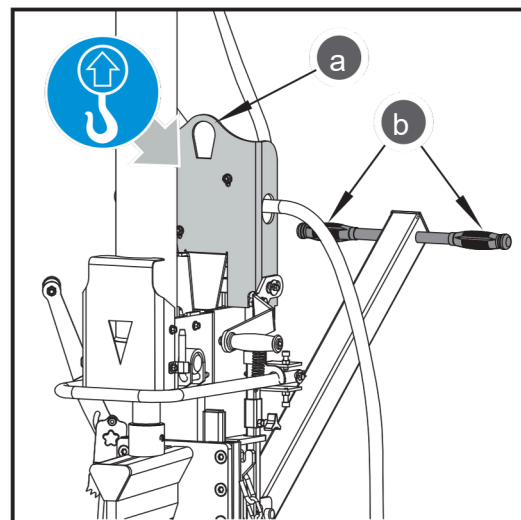

If using a crane, lay hoist sling at the lifting point (a). Never try to lift the log splitter at the Handle (b).

SPLITTER OPERATION

Plan your work site. Work safely and save effort by planning your work before hand. Have your logs positioned where they can be easily reached. Have a site located to stack the split wood or load it onto a nearby truck or other carrier. Position the log splitter on solid level ground.

Apply a thin coat of grease to the surfaces of the ram before operation will lengthen the durability of the ram.

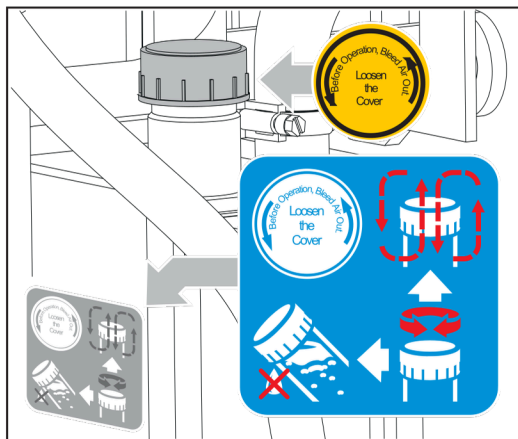

Bleed the air out of the hydraulic system before starting the log splitter. The cover of the hydraulic oil tank should be loosened by some rotations until air can go in and out of the oil tank smoothly.

Air flow thru the oil tank filler should be detectable during the operations.

Before moving the log splitter, make sure the cover of the oil tank is tightened to avoid oil leaking from this point.

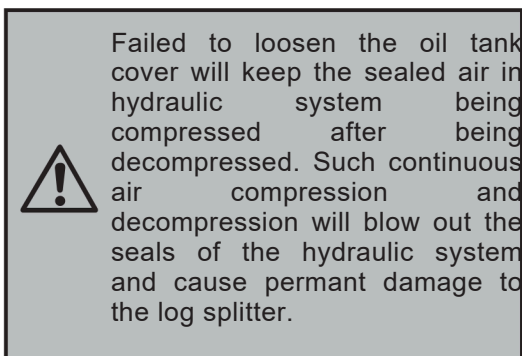

Motor

Turn the motor switch to the ON position to start the log splitter. To stop the machine, just turn the motor switch to the OFF position.

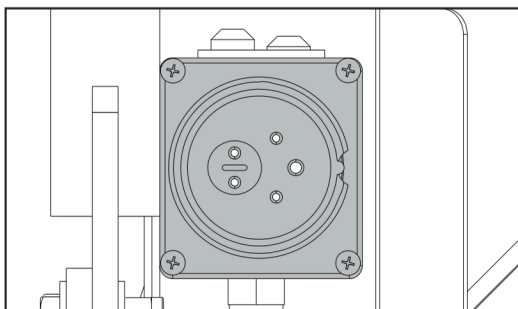

Make sure the direction of motor rotation. Turn the motor on, the wedge ram should rise to the highest position automatically. If the wedge ram is already at the highest position when the motor starts, grip both control levers and lower them, the wedge ram should start to move downward.

In case, no ram motion detected after the motor starts, power off the motor immediately to change motor polarity by turning the pole switching device inside the plug with a screwdriver.

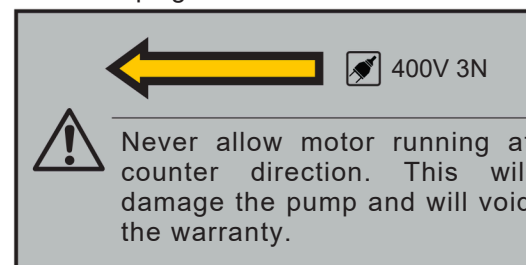

Splitting

1. Place the log vertically on the support table, so that it lies flat on its face. Press the left lever to lower the extended log fixing claw against the log to secure it. The extended log fixing claw can be adjusted to fit logs with different heights.

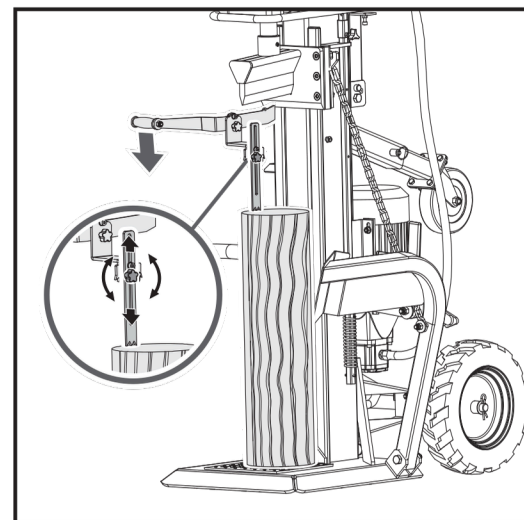
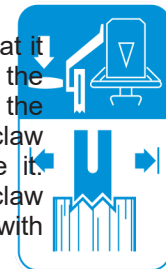



2. Hold the left press lever.

Meanwhile, move the splitter wedge down by pressing the right splitting lever to the half stroke to split the log slowly first and then press it to the end until the log is completely split.

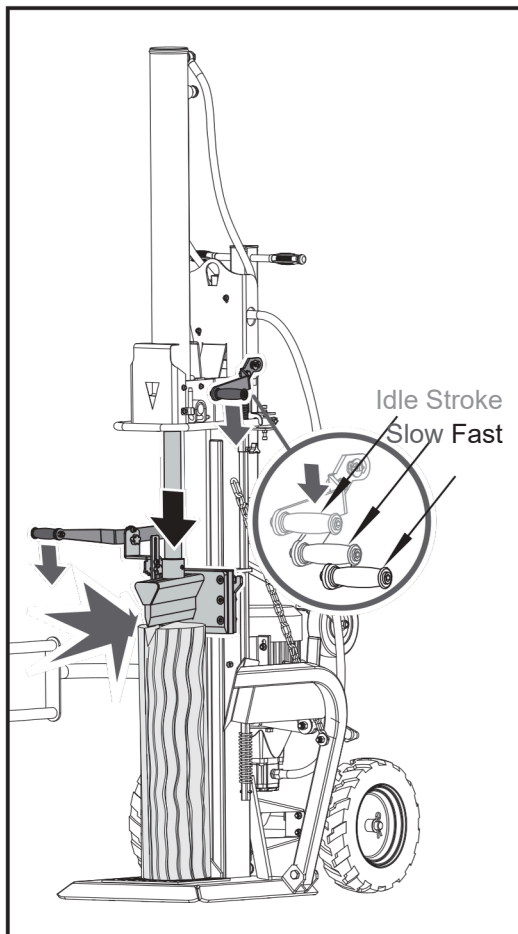
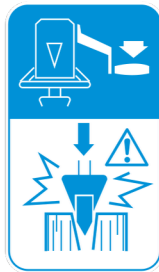

3. Return the splitter wedge to the starting position. Operate the spring-loaded retract control lever to lift wedge above the height of log to be split.

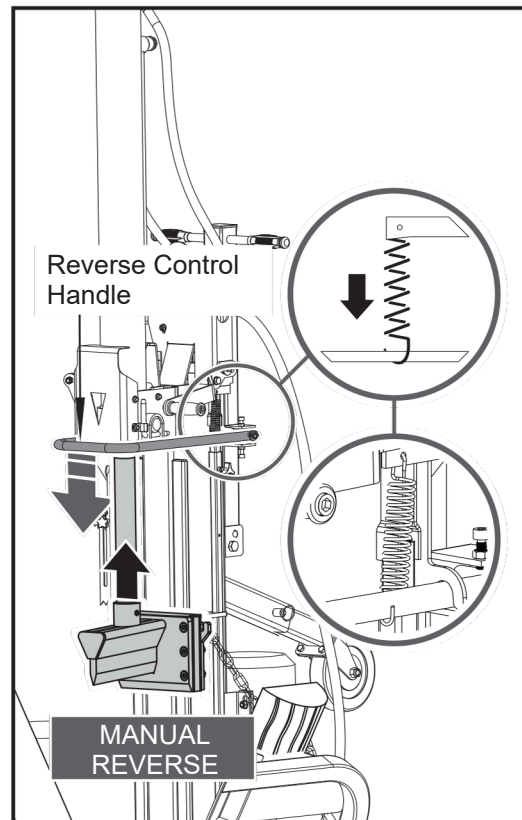
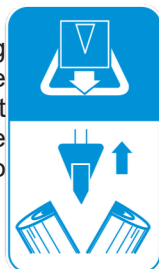

The spring is already connected to the handle in factory.

Splitting Lever

The splitting force and speed are governed by the splitting lever.

The first half stroke of the splitting lever is idle speed; press the splitting lever to the half stroke for maximum splitting force at slower speed to split the log at the beginning or particularly hard and seasoned logs;

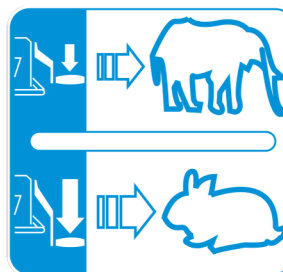

Press the splitting lever to the end for faster speed at less splitting force to finish the splitting or to split usual logs.

It can be shifted by simply raising and lowering the splitting lever slightly.



Do not attempt to split green logs. Dry, seasoned logs split much more easily, and will not jam as frequently as green wood.



Break log in the direction of its growing grain. Do not place log across the log splitter for splitting. It may be dangerous and may seriously damage the machine.



Do not remove jammed logs with your hands. Never use another people to help you with freeing jammed log.

Stack as you work. This will provide a safer work area, by keeping it uncluttered, and avoid the danger of tripping, or damaging the power cord.



Accumulated split wood and wood chips can create a hazardous work environment. Never continue to work in a cluttered work area which may cause you to slip, trip or fall.

FREE A JAMMED LOG

Do not remove jammed logs with your hands. If jammed, stop the motor and loosen the log by a downward stroke on the log with a hammer.

REPLACING OIL

The hydraulic system is a closed system with oil tank, oil pump and control valve. Low oil levels can damage the oil pump. Check oil level regularly with dipstick. The oil should be completely changed once a year.

Following hydraulic oils or equivalent are recommend for the log splitter's hydraulic transmission system:

SHELL Tellus 22
MOBIL DTE 11
ARAL Vitam GF 22
BP Energol HLP-HM 22

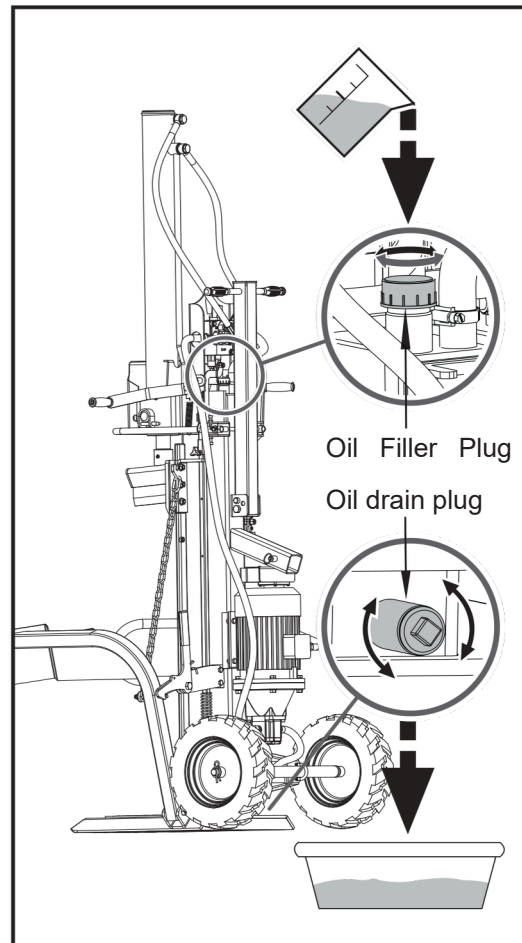

Use a drain pan to aid in the removal of all used oil and particles.



Remove oil drain plug to drain oil from the hydraulic transmission system. Examine oil for metal chips as a precaution to future problems.

After oil has been completely drained from the machine, reinstall drain plug.

Add the hydraulic transmission system with recommended oil through filler plug opening.

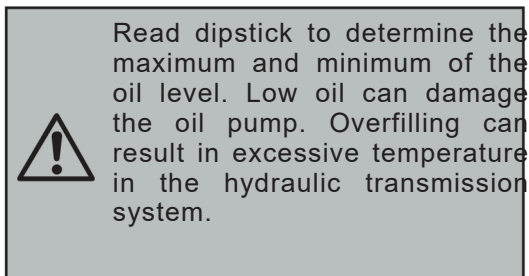
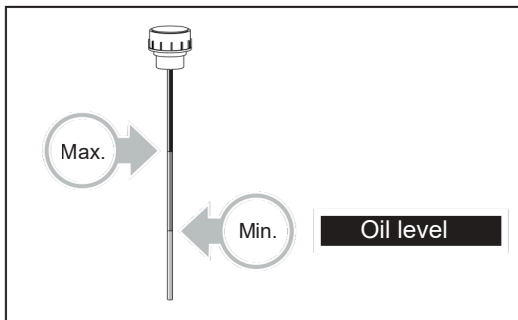

Apply sealant to filler plug and reinstall it.

Following an oil change, activate the log splitter a few times without actually splitting.

SHARPENING WEDGE

This log splitter is equipped with reinforced splitting wedge which blade is specially treated. After long periods of operation, and when required, sharpen the wedge using a fine-toothed file removing any burrs or flat spots on the edge.



TROUBLE SHOOTING

PROBLEM	PROBABLE CAUSE	REMEDY SUGGESTED
Motor does not start	Switch is OFF	ON the switch Change pole
Incorrect motor rotation direction	Incorrect connection	switching device in the plug with a screw driver Reverse polarity by electrician
		Check and tighten the parts
Log Splitter does not work while motor running	Valve is not opened owing to the connection parts loosening Control Levers or connection parts bent	
		Repair the bent parts
	Lower hydraulic oil level	Check and refill hydraulic oil
Log Splitter works with abnormal vibration and noise	Lower hydraulic oil level	Check and refill hydraulic oil



ATTENTION: ALL REPAIR WORK MUST BE DONE BY A SPECIALIST FOR THIS PRODUCT.



WIRING DIAGRAM

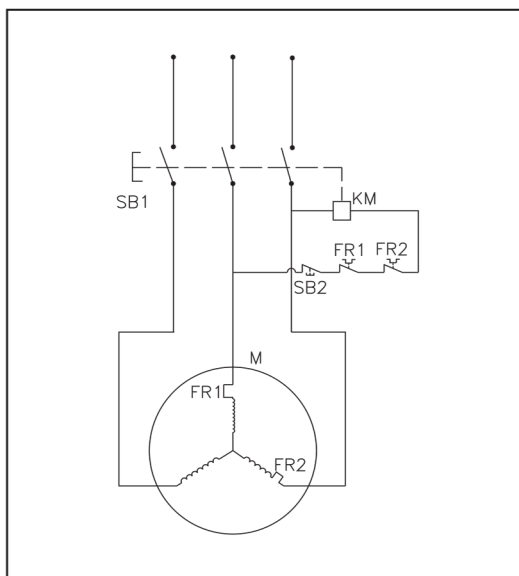

HYDRAULIC SYSTEM DIAGRAM

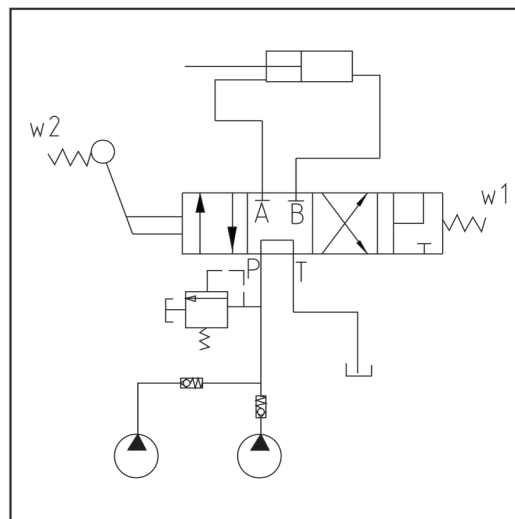



PARTS SCHEMATIC

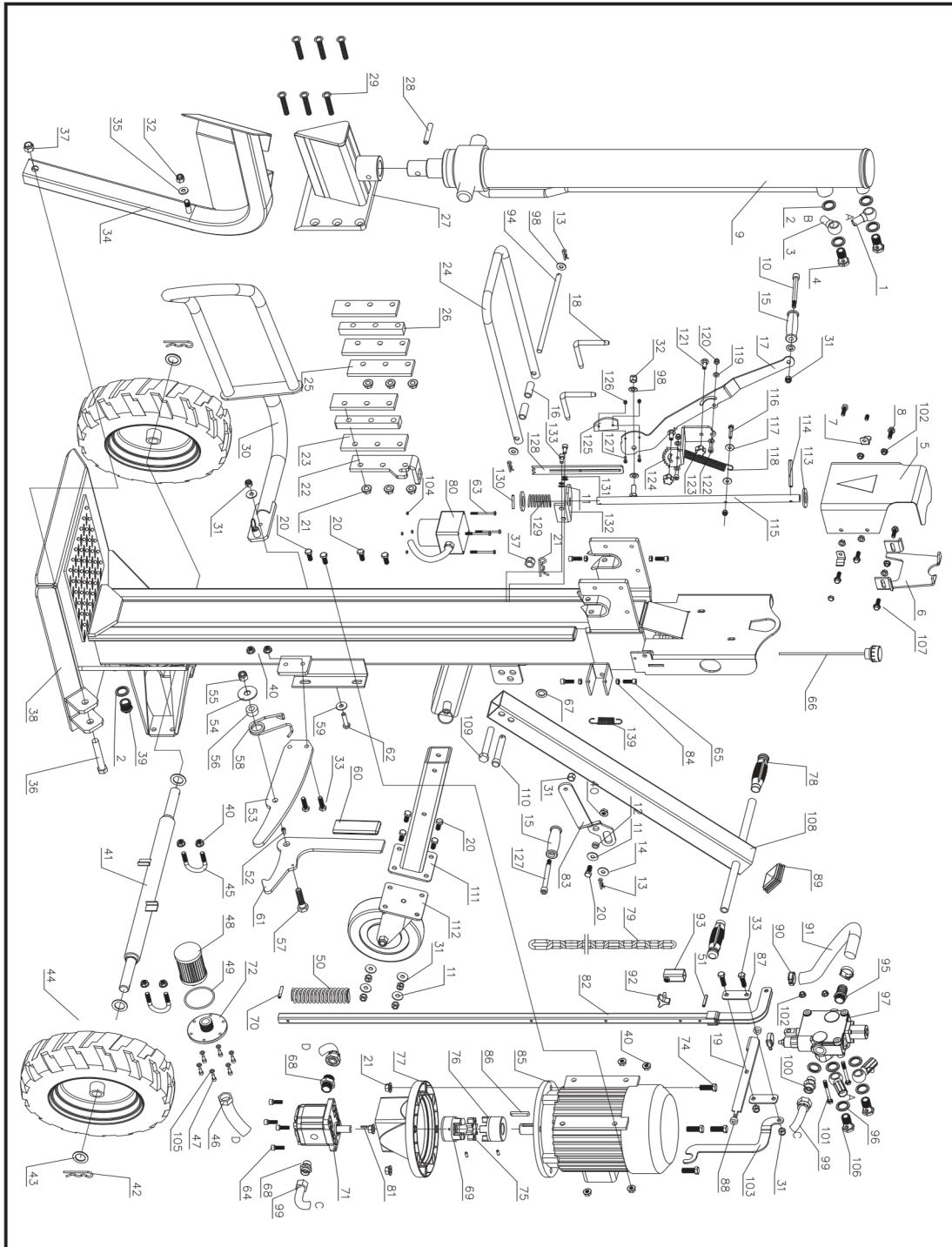



Parts List

No.	Description	Q'ty
1 2	Upper High Pressure Hose	1 5
3 4	Seal Kit 22 Lower High	1 2
5 6	Pressure Hose D12 Hose Link	1 1
7 8	Upper Guard Cylinder Lock	2 4
9	Plate Pin Bolt M8x25 Cylinder	1 2
		8 2
		4 2
		2 2
		1 2
10	Screw	1 10
11 12	Washer 10 (Small)	10 1
19 20	Screw 22 23 24 25 26	4 1
27	Wedge Weld On (Big)	1 2
	Grip Sleeve	1 1
	Pressured Lever	8 1
	Cylinder Pin	7 2
	Operated Plate Bolt	4
	M10×25 Flange Nut	
	M12 Plate Right	
	Plate Middle Lock	
	Stop Plate Left	
	Clamp Plate	
28	Pin 12×70 Screw	
29	M12×70 Guard	
30	Bracket Left Locknut	
31	M10 Locknut M12	
32	Bolt M10×35	
33		

No.	Description	Q'ty
34 35	Washer 12 (Middle)	1 1
	Host Guard	1 2
36 37	Bolt M16×90 (Short)	1 1
	Splitting Frame Weldment	1 1
	Nut M16	12 1
		2 4
39 40	Plug M22×1.5	2 2
43	Flange Bolt M10	1 6
44	Washer 24	
	Wheel Axle Pin 4	1 1
		1 1
		1 1
44 45	Tube Bolt	1 1
		1 1
46	Inlet Hose	1 2
47	Screw M6×14	1 1
48	Oil Filter	1 4
49	O-Ring 80×3.1	4 4
50 51	Bolt 63 54 Wgs Pier 6×35	1
14 (Big)	Screw M6×10 Lift	
	Frame Lock Plate	
55	Nut M14	
	Lock Spring	
58 59	Washer 16 (Middle)	
60	Grip	
61 62	Retaining Hook	
64 65	Bolt M10×40	
Cap	Screw M4×60	
	Screw M8×30	
	Screw M8×25	



No.	Description	Q'ty
67	Washer 16	12
68	Hose Fitting(Zg1/2-M22× 1.5	11
69	Coupler	11
70	Pin 6×45	41
71	Pump	11
72	Flange Bolt	21
76	M12×45	11
79	Coupler Ring	11
80	Coupler 2 Cone	41
81	Frame Handle	12
	Sleeve	11
		21
		11
		11
81	Drive Bar	51
82	Arm Right	61
	Nut M8	12
		1
85	Spline 8×50 Fitting	
86	Plate 60×60	
87	Round Plate	
88	Washer	
89	Clamp 18-32 Oil	
90	Return Hose D20 Knob	
91	Regulating Sleeve	
92	Lock Shaft Hose Fitting	
93	Seal Kit 22 Valve	
94		
95		
96		
97		
98	High Pressure Hose	
99	Half Union	
100	Screw M8×65	
101	Washer 12 (Middle)	

No.	Description	Q'ty
102	Flange Nut M8	8 1
103	Lock Nut M8	4 6
105	Washer 6	2 2
		1 1
106	Valve Fitting	1 1
107	Bolt M8×30 108Draw Bar	1 2
109	Weldment Bolt M16×100	1 1
	(Long)	1 2
11	Pin 16 Straight	1 4
0	Weldment	3 2
112	Wheel Assy	2 2
113	Washer 22	1 1
114	Pin 8×70	2 2
	Adjustable Bar Weldment	1 1
		1 1
116	Bolt 8×45	1 2
	Washer 8	1 2
	(Middle)	1
118	Reset Extension Spring	
8		
120	Lock Nut M8 Bolt	
121	M10×22 Bolt 123×204Log	
	Adjustable Handle	
125	120NytFriction Pad	
M5		
127	Bolt 5×16	
	Extended Log Fixing Claw	
12	Reset Spring	
130	Pin 5×35	
131	Spring Gasket 10	
134	Support Plate Bolt	
	10×20	