



HAHN A SYN s.r.o.
Lelkova 186/4
747 21 Kravaře
CZECH REPUBLIC
info@hahn-profi.cz

Hahn & Sohn GmbH
Janahof 53
93413 Cham
Deutschland
hahn@hahn-sohn.de

USER'S MANUAL



ELECTRIC SHREDDER

MODEL NUMBER: **CEDRE04**

SERIAL NUMBER:

Both the model number and serial number can be found on the main label.
Please keep both numbers and keep them in a safe place for later use.



CONTENTS

Foreword 3

Introduction..... 4

Puopse..... 4

Contents.5

Description6

Way of working..... 8

Technical Data.. 8

Safety Symbols..... 9

Safety features..... 11

Assembly..... 15

Operation..... 17

Maintenance 19

Storage 20

Disposal..... 20

Troubleshooting 21

FOREWORD

Thank you for purchasing our device!

This user manual contains the most important information about the device, its design, functions, and use. Before starting work, please read the user manual carefully. Safe and correct use will ensure the best results. All information contained in the manual is based on the latest product data as of the date of printing. Due to continuous device improvement and changes, the user manual may differ from the actual device. The manufacturer reserves the right to make changes to the product at any time. Product parameters are subject to change without notice. Copying or duplicating the user manual or its components without the manufacturer's consent is prohibited. This user manual should be considered an integral part of the device and should be included with the device if transferred to a third party or resold. Operating the device in accordance with the user manual and the messages contained therein is crucial to ensuring long-term and safe operation of the device and to meeting user expectations. Failure to read, understand, or follow the user manual may result in serious injury and damage to the device. CEDRUS is not responsible for any printing errors in this manual that do not directly affect the use of the device and only concern detailed technical or descriptive data. Devices are updated during production, therefore some data contained in this manual may differ from actual data, which also does not affect the use of the device.

The photos and illustrations contained in this manual are for illustrative purposes only, and the physical condition of the device may differ from the actual condition.

INTRODUCTION

This machine was quality-tested and subjected to a final inspection during production, ensuring its functionality. In some cases, lubricant residue may be present on or inside the machine. This is not a defect or malfunction and is not a cause for concern. This instruction manual is part of this machine. It contains important information regarding safety, use, and disposal. Before using the machine, please read all operating and safety information. Use the shredder only as described and for the intended applications. Keep this manual in a safe place and pass it on to any subsequent users so that this information is always available.



PURPOSE

This appliance is intended for shredding fibrous or woody garden waste, such as hedge and tree trimmings. Any other use not expressly approved in this instruction manual may damage the appliance and therefore pose a significant risk to the user. The shredder must not be filled with stones, glass, metal, bones, plastic, or textile waste. This appliance is not suitable for commercial use. The warranty is void for commercial use. Any other use not expressly approved in this instruction manual may damage the appliance and therefore pose a significant risk to the user. Do not use the appliance in rain or wet conditions. The operator or user is liable for any accidents, injuries, or material damage to third parties or their property. The manufacturer is not liable for damage caused by improper use or incorrect operation.

ZAWARTOŚĆ

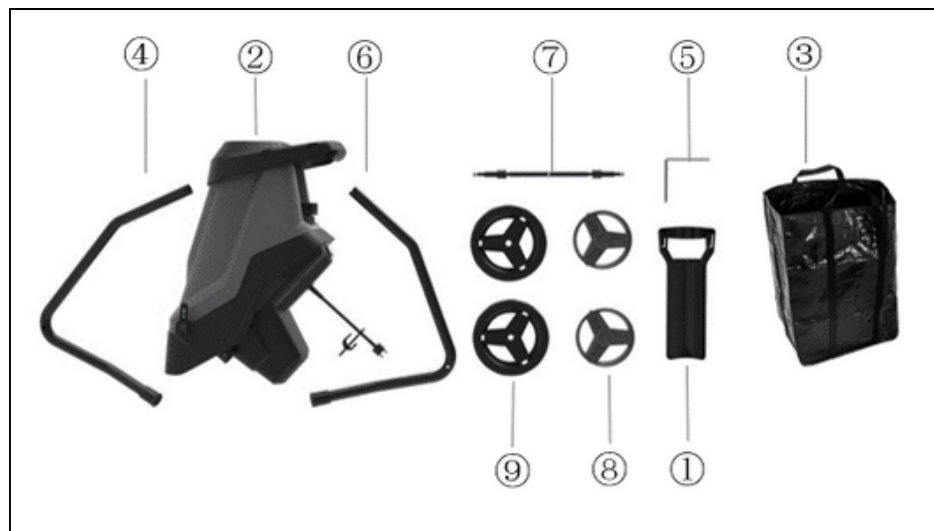

- 1. Pushrod
- 2. Housing
- 3. Tank
- 4. Right Bracket
- 5. Allen Key
- 6. Left Bracket
- 7. Axle
- 8. Hubcaps
- 9. Wheels



DESCRIPTION

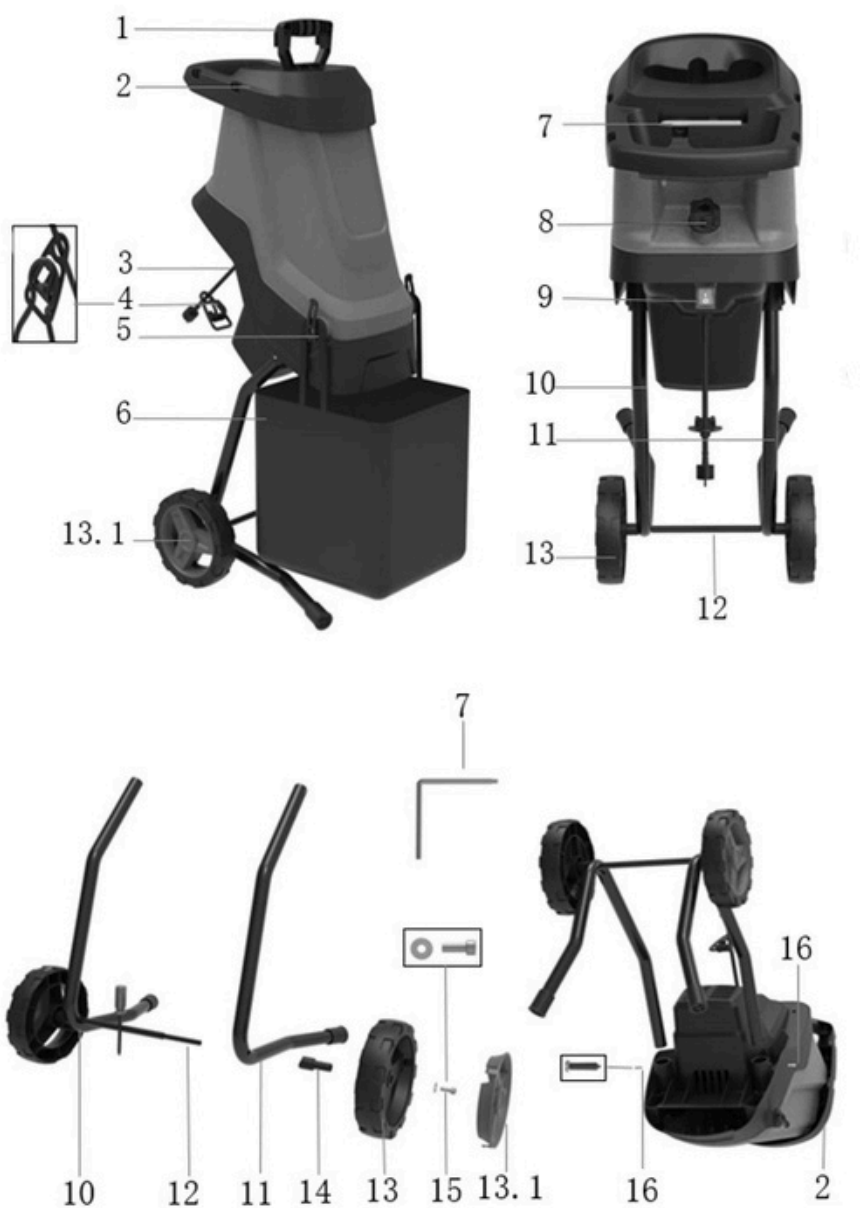

1. Pusher
2. Feeder
3. Power Cord
4. Cord Clip
5. Hopper Mount
6. Hopper
7. Allen Key
8. Housing Lock
9. Switch
10. Left Bracket
11. Right Bracket
12. Axle
13. Wheel (13.1 Hubcap)
14. Bushing
15. Screw and Washer
16. Screw
17. Blade
18. Blade Plate
19. Access Hole
20. Screw (screwdriver not included).

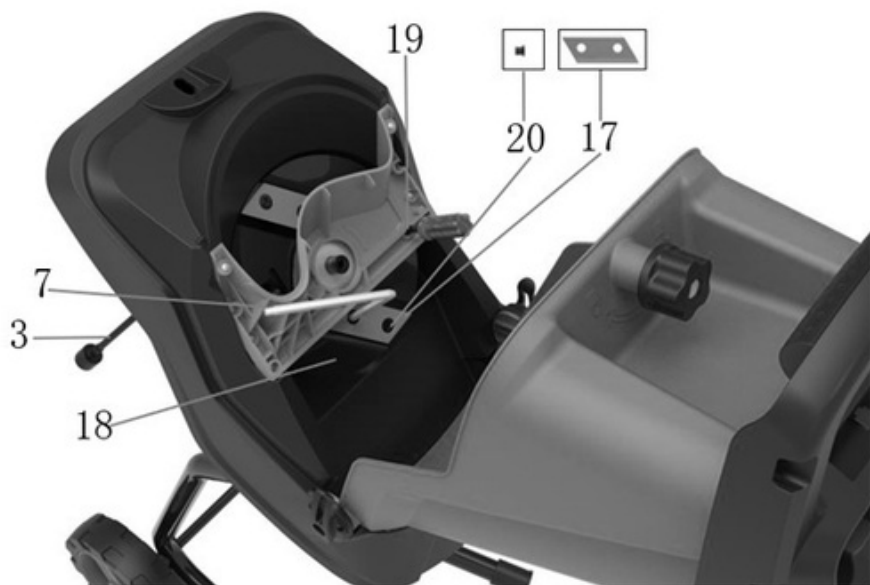

WAY OF WORKING

The shredder is equipped with a powerful electric motor with overload protection. A knife system serves as the cutting mechanism. Sturdy supports ensure stability and good mobility. Read the following sections to learn more about the functions of each operating element.

TECHNICAL SPECIFICATION

Model	CEDRE04
Znamionowa moc wejściowa	2800 W (P40)*
Mains voltage	220-240 V~; 50 Hz
Protection class	□ II
Degree of protection	IPX4 **
Idle speed	4500 min-1
Maximum branch thickness	45 mm***
Basket capacity	ok. 45 l
Weight	ok. 8,7 kg
Sound pressure level	(LpA) 95,8 dB(A), KpA= 3 dB(A)
measured	Sound power level (LWA)
guaranteed	103,37 dB(A), KWA= 3 dB(A)
	106 dB(A)

* Continuous operation with intermittent loading of the material to be shredded (40 seconds charging - 60 seconds idle operation without shredding)

** The plug is suitable for indoor use only.









*** The maximum branch thickness that can be shredded depends on the type of wood and the properties of the shredding material.









The maximum branch thickness that can be shredded for hardwood (e.g., oak and beech branches) is smaller than for softwood (e.g., pine/spruce). Dry or rotten wood also means a smaller thickness that can be shredded.

Noise levels are determined in accordance with the standards and regulations contained in the Declaration of Conformity.

SAFETY SYMBOLS

Improper use of this device can result in serious injury. Before operating this device, read this manual carefully and familiarize yourself with all controls. Keep this manual in a safe place and pass it on to any subsequent users so that this information is always available.

<i>Warning symbols in the user manual</i>	
	Indicates a hazardous situation that could result in death or serious injury.
	Indicates a hazard which, if ignored, may result in damage and injury due to electric shock.
UWAGA!	Indicates a hazard that, if ignored, could result in injury. Warns of possible damage and provides useful information regarding installation or use.
Warning symbols on the device	
	Attention!!
	Please read the instruction manual!
	Eye and hearing protection should be worn
	Protective gloves should be worn
	Do not expose the device to rain
	WARNING! Turn off the appliance and unplug it from the socket before changing any settings, cleaning the appliance or if the cord is damaged.
	DANGER! Rotating cutting blades. Keep hands and feet away from openings while machine is operating.

	Protection class II
	Do not step on the device!
	WARNING! Danger from ejected parts! Keep away from the feeder and ejection area. Keep other people away.
	Wait until any parts of the machine have come to a complete stop before touching them.
	Guaranteed sound power level
	Do not dispose of the device with household waste.
	The plug is intended for indoor use only.
	Open the housing lock
	Lock the housing lock

SAFETY FEATURES

 ***In the event of an accident or malfunction during operation, turn off the device immediately. Injuries should be treated appropriately or medical attention should be sought. Refer to the "Troubleshooting" section to resolve any faults or contact an authorized service center.***

- ☐ Read the instructions carefully. Familiarize yourself with the controls and proper operation of the appliance.
- ☐ Children, people with limited physical, sensory, or mental capabilities, or those who lack experience or knowledge, or who have not read the instructions, should never use the appliance. Local regulations may specify age limits for users.
- ☐ Never use the appliance if people, especially children, or pets are nearby.
- ☐ Remember that the user is responsible for any accidents or hazards occurring to other people or their property.

Preparation

- ☐ ☐ Wear hearing protection and safety glasses. These must be worn at all times when operating the machine. There is a risk of hearing and eye damage.
Always wear sturdy footwear and work trousers when operating the machine. Do not operate the machine barefoot or in open sandals. Avoid wearing loose clothing or clothing with hanging ribbons or strings. These can become entangled in the feeder and cause serious injury.
- ☐ Use the machine only outdoors (i.e., not against a wall) and only while standing firmly on a level surface.
- ☐ Do not use the machine on a paved or gravel surface where thrown material could cause injury.
- ☐ Before starting the machine, always visually inspect the machine, cutting tools, screws, and other fasteners to ensure they are secure, the housing is undamaged, and safety equipment and guards are in place. Replace damaged or worn parts as a set to ensure the machine remains balanced. Damaged or illegible labels must be replaced. Before operating the machine, always visually inspect the power cord and extension cord for damage or wear. If the power cord becomes damaged during use, immediately disconnect it from the power source. Do not touch the power cord before disconnecting it from the power source. Do not use the machine if the power cord is tangled, damaged, or worn.

OPERATION



Before turning on the machine, ensure the feeder is empty. Keep your head and body away from the feeder opening.

Do not allow your hands, other body parts, or clothing to enter the feeder, discharge chute, or hopper, or to be near moving parts.

Stand firmly and maintain balance. Avoid incorrect posture while working. Do not lean forward. When feeding material, never stand higher than the base of the machine.

Always stand outside the discharge area when operating the machine.

Do not use the machine in rain or in inclement weather, especially when there is a risk of lightning strike. Work only in daylight or in areas with adequate lighting.

Do not operate the machine if you are tired, lack concentration, or have consumed alcohol or pills. Always take regular breaks. Use common sense. When feeding material, ensure it is free from metal, stones, bottles, cans, or other foreign objects.

- ☐ If foreign objects get inside, or if the machine generates unusual noises or vibrations, immediately turn off the power and stop the machine. Disconnect the machine from the power supply and perform the following steps before restarting and restarting the machine:

- Inspect the machine for damage;
 - Replace or repair any damaged parts;
 - Check for loose parts and tighten them if necessary.

- ☐ Ensure that material being processed does not accumulate in the discharge area; this could prevent proper discharge and cause material to be thrown back out the feed opening.
- ☐ If the machine becomes clogged, turn off the power and unplug the machine from the power source before cleaning. Ensure the motor is free of debris and other deposits to protect the motor from damage or the possibility of a fire.
- ☐ Do not operate the machine with damaged or defective safety devices or guards, or if safety devices are not in place.
- ☐ Do not operate the machine with a damaged or worn cord. Do not connect a damaged cord to the power source.
- ☐ Keep extension cords away from dangerous moving parts to prevent damage to the cords, which could lead to contact with live parts.
- ☐ Keep ventilation openings free of debris and other deposits to protect the motor from damage or the possibility of a fire. Do not transport the machine while the engine is running.

- ☐ Turn off the appliance and unplug it. Make sure all moving parts have come to a complete stop:
 - before leaving the machine;
 - before clearing blockages or cleaning clogged lines;
 - if the power cord or extension cord is damaged or entangled;
 - before checking, cleaning, or working on the machine.
- ☐ Do not overload the machine. Operate only within the specified power range. Observe the maximum specified branch thickness. Do not use the machine for purposes for which it was not intended. Only switch off the machine after the chute is completely empty;
- ☐ otherwise, the machine may become clogged and, under certain circumstances, may not restart. Do not use the machine if the switch cannot be turned on or off. Damaged switches must be replaced by an authorized service center. Use only splash-proof extension cords approved for outdoor use. The wire cross-section
- ☐ of the extension cord must be greater than 1.5 mm². Always fully unwind the cable drum before use. Inspect the cable for damage.
- ☐ Do not use the cable to pull the plug from the socket. Protect the cable from heat, oil, and sharp edges.

Maintenance and storage

- ☐ When stopping the appliance for maintenance, inspection, or storage, or when changing accessories, turn it off, unplug it, and make sure all moving parts have come to a complete stop. Before performing maintenance, adjusting settings, etc., allow the appliance to cool down. Keep the appliance clean and well-maintained.
- ☐ Store the appliance in a dry place out of the reach of children.
- ☐ always allow the appliance to cool down before storing.
- ☐ When servicing the shredding unit, remember that it may still move even if the power is turned off by the interlock function or safety devices.
- ☐ For safety reasons, replace worn or damaged parts. Use only original parts and original accessories supplied and recommended by the manufacturer. The use of third-party parts will immediately void any warranty claims.
- ☐ Never attempt to bypass the interlock function of the safety equipment. Do not attempt to repair the device yourself unless you have professional training. Any work not specified in this manual must only be performed by an authorized service center.
- ☐ If the power cord of this device is damaged, it must be replaced by an authorized service center to avoid hazards.

Installing the collection bag

- ☐ Turn off the device before installing or removing the basket.

Recommendations

- ☐ The machine should be powered by a residual current device (RCD) with a rated residual current of no more than 30 mA.
- ☐ Avoid using the machine in poor weather conditions, especially if there is a risk of lightning strikes.

Other threats

Other hazards always exist, even when the device is operated according to the instructions. Due to the type and design of this device, the following hazards may occur:

- a) hearing damage if proper hearing protection is not worn
- b) Eye damage if proper eye protection is not worn.

 **WARNING!** This device generates an electromagnetic field during operation. Under certain circumstances, this field may adversely affect active or passive medical implants. To reduce the risk of serious or fatal injury, users with medical implants should consult their physician and the implant manufacturer before operating this device.

ASSEMBLY

Unpacking the device

1. Open the package.
2. Read the instructions included in the package.
3. Remove all unassembled parts from the box.
4. Remove the device from the box.

NOTE! Dispose of the bag and packaging material according to local regulations. Installing the wheels and brackets

NOTE: Mounting the wheels one by one makes assembly easier.

1. Loosen the bolt and washer (15) and the bushing (14) from the axle (12) using the Allen key (7).
2. Insert the axle (12) into the left bracket (10).
3. Place the bushing (14), which allows the wheel to rotate freely, on the axle with the curve facing the bracket.
4. Place the wheel (13) without the cover onto the bushing (14).
5. Secure the wheel (13) securely using the Allen key (7), bolt, and washer (15). Tighten the bolt securely by turning the Allen key (7). Meanwhile, secure the axle (12) in the hole on the axle (12) using a screwdriver.
6. Install the right bracket (11) and the second wheel (13) in the same manner.
7. Press the wheel covers (13.1) onto the wheels (13) to cover the ends of the axles (12). You can use a hammer (not included) to seat them securely onto the axles. There may be some play between the wheel and the wheel cover. It is not necessary to press it all the way in.

Mounting the brackets

1. Turn the unit upside down. Loosen the screw (16) on the housing with a screwdriver. Slide the brackets (10 and 11) into the shredder.
2. Secure the brackets (10 and 11) with the screw (16).

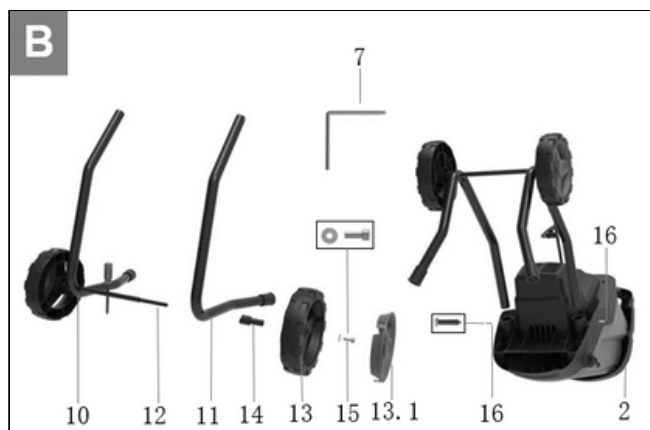

Accessory Location

1. 1. The pusher (1) should be placed evenly in the feeder (2).
2. 2. The Allen key (7) should be located at the back of the feeder (2).

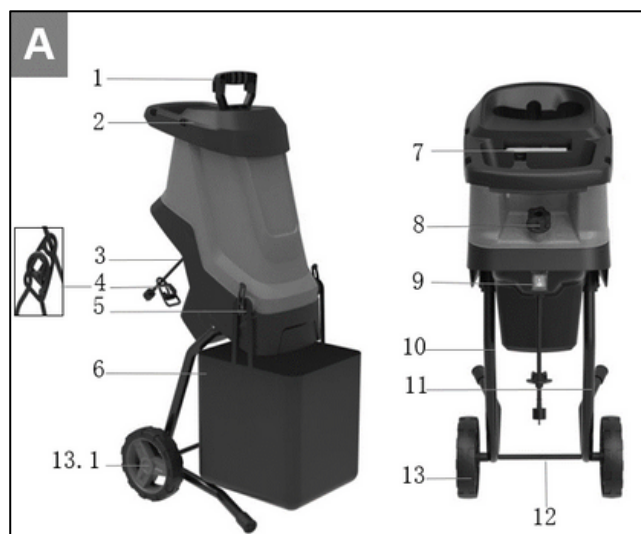

OPERATION

NOTE! The feeder must be empty.

- ☐ Hang the tank (6) on the mountings (5) on the right and left side of the device housing.

Turning on and off

NOTE! Make sure that the mains voltage matches the data on the rating plate.

1. Make a loop with the end of the extension cord and hang it on the cord clip (4) on the power cord (3). See the detailed illustration.
2. Connect the extension cord to the power cord (3).
3. Turn the device to the "I" position using the switch (9).
4. To turn the device off, slide the switch (9) back to the "O" position.

 Risk of injury from rotating blades! The blades will continue to operate for a short time after being turned off.

Emptying the bag

CAUTION! Before emptying the bag unplug the power cord. Empty the bin immediately and be aware that it fills unevenly!

1. Turn the device to the "O" position using the switch (9).
2. Remove the tank (6) and empty it.
3. Reattach the tank (6) to the mounting brackets (5).

Overload protection



In the event of an overload, e.g., due to branches that are too thick, the machine will stop automatically. To restart, turn the machine off and set the switch (9) back to the "I" position.

Restarting after a blockage



1. Slide the switch (9) back to the "O" position and pull out the power cord (3).

2. Remove the obstruction. Lock the housing lock (8). Connect the extension cord to the power cord (3).

General information about work



-  When shredding, maintain a sufficient distance from the machine, as long branches may bounce during feeding. This poses a risk of injury.
-  Wear eye and hearing protection. Wear protective gloves. This poses a risk of injury.
- ☐ Fill the feed chute with the material to be shredded. When feeding branches into the machine, hold them until they are automatically drawn in. The material will be drawn in and shredded.
- ☐ Observe the shredder's feed speed and do not overload the machine.
- ☐ To prevent clogging, shred branches alternately with thin twigs and withered garden waste that has been stored for several days.
- ☐ Before shredding, remove soil and stones from the roots to prevent the blades from becoming dull.
Do not shred soft, damp material, such as kitchen waste. Instead, compost it.
Only turn off the machine once all the shredded material has passed through the blade system. Otherwise, the blade may jam when restarting.

Removing blockages

-  Before performing any maintenance or cleaning work, turn off the appliance, unplug it, and wait for the blades to stop.
 -  There is a risk of electric shock, fire, and injury from the rotating blades. Wear protective gloves. There is a risk of injury.
1. Make sure the power cord (3) is unplugged from the power source.
 2. Release the housing lock (8).
 3. Tilt the front of the shredder housing forward.
 4. This will provide free access to the blades (17).
 5. The blockage can now be cleared.

NOTE! This machine is equipped with a safety switch. The housing lock must be retightened by hand, otherwise the machine will not be able to be started later.

KONSERWACJA I CZYSZCZENIE

-  Any work not described in this manual should be performed by an authorized service center.
-  Use only original parts. Wear gloves when handling the blade. Risk of injury.

Before performing any maintenance or cleaning work, turn off the appliance, unplug it, and wait until the blade has come to a complete stop. There is a risk of electric shock, fire, and injury from the rotating blades.

General cleaning and maintenance

-  Do not spray the shredder with water. Danger of electric shock!
 - ☐ Always keep the machine, wheels, and air vents clean. Use a brush or cloth to clean, but
 - ☐ do not use any cleaning agents or solvents.
 - ☐ Inspect the machine before each use for damage, such as loose, worn, or damaged parts.
 - ☐ Ensure that all nuts, bolts, and screws are securely tightened.
- Inspect guards and safety devices for damage and proper fit. Replace them if necessary. Store the machine in a dry place out of reach of children. Do not seal the machine in nylon bags, as this can cause moisture buildup.

Rotating or replacing the blades

-  Before performing any maintenance or cleaning, turn off the appliance, unplug it, and wait until the blades have stopped. There is a risk of electric shock, fire, and injury from the rotating blades.

1. Ensure the power cord (3) is unplugged from the power source.
2. Release the housing lock (8).
3. Tilt the front of the shredder housing forward to gain access to the blades (17).
4. Lock the blade plate (18), for example, using a screwdriver (not included). Insert the screwdriver through the access hole (19) and carefully rotate the blade plate (18) until you reach one of the two locking holes. You can now insert the screwdriver through the blade plate (18) to lock it.
5. Use the Allen key (7) to loosen the two screws (20) and remove the blade (17).

When assembling the blade, ensure that only new screws are used and tighten them to 12 Nm using a torque wrench.

CAUTION! The blades have two cutting edges that can be rotated. Always replace and rotate the blades in pairs. Do not attempt to sharpen the blades.

CAUTION! The machine is equipped with a safety switch. The housing lock must be retightened by hand, otherwise the machine will not be able to be started later.

STORAGE

- ☐ Store the device in a dry place, out of reach of children.
- ☐ Allow the device to cool before storing it in an enclosed space.

NOTE! We are not liable for any damage caused by our device if it is caused by improper repair, use of non-original parts, or use contrary to the instructions.

DISPOSAL

The device, accessories, and packaging should be recycled appropriately.

Electrical devices should not be disposed of with household waste.



- ☐ Please take your device to a recycling facility. The plastic and metal parts used in the device can be properly sorted by material and type and recycled effectively.

TROUBLESHOOTING

Problem	Reason	Solution
The engine is not running	Power failure / device not connected to a working outlet.	Check that the device is plugged into a working outlet. Make sure the extension cord is not damaged.
	The overload protection has tripped.	Remove any shavings. Press the power button to restart the machine.
	The housing cover is open.	Check that the housing cover is secured and that the housing lock is tightened.
Garden waste is not collected	Material is blocked in the feeder.	Disconnect the power and open the housing cover. Remove the material from the feeder.
	The cutting blades are blocked	Disconnect the power and open the housing cover. Open the blade guard. Remove the jammed material and reinstall the blade guard and housing cover.
	Shredded material in the discharge chute.	Pull out the plug, wait for the blades to stop, remove the shredded material from the discharge chute.
The machine does not grind satisfactorily	The blades are worn.	Reverse the blades by unplugging the unit. The reversible blade is attached to the blade plate with two screws. Insert a screwdriver-like metal rod through the access hole (19) and carefully rotate the blade plate (18) until you access one of the two locking holes. Use the included Allen key to unscrew the screws and remove the blade.